

Load Paper Sheets In The Paper Cassette Drawer

Follow these steps to load cut sheets in the paper cassette:

1. Make sure the printer is turned on, then press the ◀ Paper Source button and press ▼ to highlight CUT SHEET.
2. Press OK.
3. The sheet □ icon appears on the LCD screen.
4. Lift the edge of the output tray to remove it.
5. Slide open the paper cassette, lift it slightly and then pull it out.
6. If your paper is 11x14 or larger, extend the paper cassette to match the size of the paper.
7. Slide the edge guides outward.
8. Load the sheets with the printable side face-down, in the portrait orientation (short edge first). Place the paper all the way back in the paper cassette and next to the right edge. Make sure the stack of paper fits under the arrow on the left edge guide.
9. Slide the edge guides against the paper, but not too tightly.
10. Insert the paper cassette. Push it firmly into the printer.
11. Replace the output tray and adjust its length to fit your paper size.

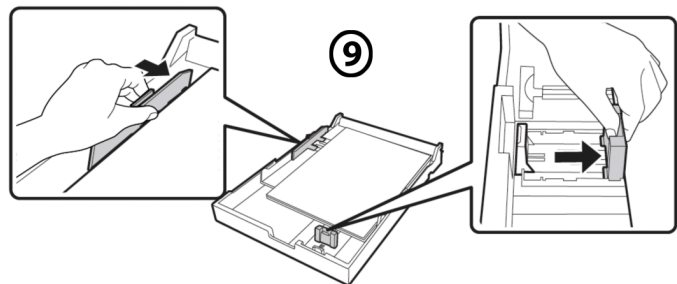
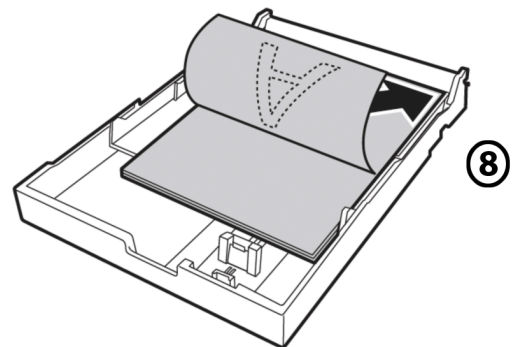
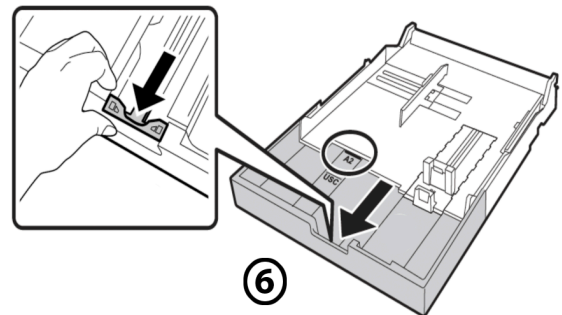
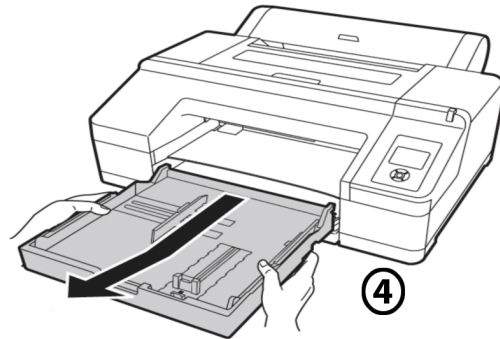

12. Read the appropriate section in the manual before creating your own custom paper sizes. It's easier to use one of these standard paper sizes.

EPSON PAPER SIZE CODES

- US Letter 8 ½ x 11 inches
- US B (Ledger) 11 x 17 inches
- Super A3/B 13 x 19 inches
- US C 17 x 22 inches